

BELMONT COUNTY, OHIO

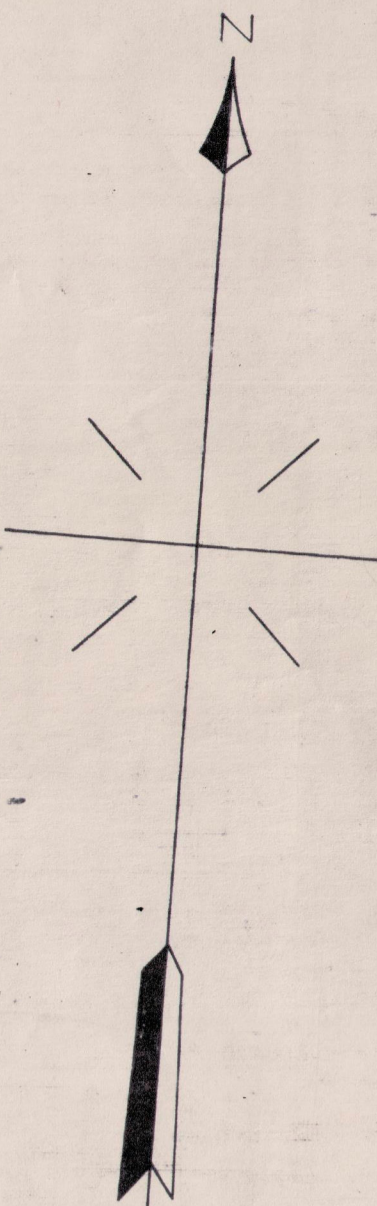

AUTHORITY	DATE INSTALLED OR RETIRED	DESCRIPTION
C 23638 A.F.E. 6811	Installed May 15-1924	Installation of 26 Piles on the right between stations 013+45 and 014+15.
C 27507 A.F.E. 10226	Installed May 20, 1926	Installation of 679 additional piling on right between stations 014+00 and 014+62, consisting of 20 piles.
C 30677 A.F.E. 13187	Completed Dec 6, 1926	Special assessment for Belmont-Silverdale Road Sta 8234 to 8284.
C 30677 A.F.E. 13187	Consummated July 28, 1929	Purchase of property Sta 747+00.

NO.	DATE	BY	DESCRIPTION	AREA
1			See on file - 11-11-1927	
2	4-10-1928	Wm. Daley	General release.	
3	4-10-1928	Wm. Daley	General release.	
4	4-10-1928	Wm. Daley	General release.	
5	4-10-1928	Wm. Daley	General release.	
6	4-10-1928	Wm. Daley	General release.	5,344
7	4-10-1928	Wm. Daley	General release.	
8	4-10-1928	Wm. Daley	General release.	
9	4-10-1928	Wm. Daley	General release.	

NO.	Revision	Reference	Date	A.F.E.	BY
1	Revision	Reference	Date	A.F.E.	BY



RECORD OF CHANGES AFTER DATE OF ORIGINAL PUBLICATION

**RIGHT-OF-WAY AND TRACK MAP**

THE BALTIMORE AND OHIO RAILROAD COMPANY  
OPERATED BY  
THE BALTIMORE AND OHIO RAILROAD COMPANY

MAIN LINE OHIO-NEWARK DIVISION

STATION 730+20 TO STATION 844+80  
SCALE 1 IN. = 200 FT. JUNE 10, 1919

OFFICE OF VALUATION ENGINEER  
BALTIMORE, MD.

REVISED TO
Dec 15, 1922
Jan 11, 1924
Mar 12, 1924
Apr 3, 1926
May 1, 1926
Jun 1, 1927
Jul 1, 1927
Aug 1, 1927
Sep 1, 1927
Oct 1, 1927
Nov 1, 1927
Dec 1, 1927
Jan 1, 1928
Feb 1, 1928
Mar 1, 1928
Apr 1, 1928
May 1, 1928
Jun 1, 1928
Jul 1, 1928
Aug 1, 1928
Sep 1, 1928
Oct 1, 1928
Nov 1, 1928
Dec 1, 1928
Jan 1, 1929
Feb 1, 1929
Mar 1, 1929
Apr 1, 1929
May 1, 1929
Jun 1, 1929
Jul 1, 1929
Aug 1, 1929
Sep 1, 1929
Oct 1, 1929
Nov 1, 1929
Dec 1, 1929
Jan 1, 1930
Feb 1, 1930
Mar 1, 1930
Apr 1, 1930
May 1, 1930
Jun 1, 1930
Jul 1, 1930
Aug 1, 1930
Sep 1, 1930
Oct 1, 1930
Nov 1, 1930
Dec 1, 1930
Jan 1, 1931
Feb 1, 1931
Mar 1, 1931
Apr 1, 1931
May 1, 1931
Jun 1, 1931
Jul 1, 1931
Aug 1, 1931
Sep 1, 1931
Oct 1, 1931
Nov 1, 1931
Dec 1, 1931
Jan 1, 1932
Feb 1, 1932
Mar 1, 1932
Apr 1, 1932
May 1, 1932
Jun 1, 1932
Jul 1, 1932
Aug 1, 1932
Sep 1, 1932
Oct 1, 1932
Nov 1, 1932
Dec 1, 1932
Jan 1, 1933
Feb 1, 1933
Mar 1, 1933
Apr 1, 1933
May 1, 1933
Jun 1, 1933
Jul 1, 1933
Aug 1, 1933
Sep 1, 1933
Oct 1, 1933
Nov 1, 1933
Dec 1, 1933
Jan 1, 1934
Feb 1, 1934
Mar 1, 1934
Apr 1, 1934
May 1, 1934
Jun 1, 1934
Jul 1, 1934
Aug 1, 1934
Sep 1, 1934
Oct 1, 1934
Nov 1, 1934
Dec 1, 1934
Jan 1, 1935
Feb 1, 1935
Mar 1, 1935
Apr 1, 1935
May 1, 1935
Jun 1, 1935
Jul 1, 1935
Aug 1, 1935
Sep 1, 1935
Oct 1, 1935
Nov 1, 1935
Dec 1, 1935
Jan 1, 1936
Feb 1, 1936
Mar 1, 1936
Apr 1, 1936
May 1, 1936
Jun 1, 1936
Jul 1, 1936
Aug 1, 1936
Sep 1, 1936
Oct 1, 1936
Nov 1, 1936
Dec 1, 1936
Jan 1, 1937
Feb 1, 1937
Mar 1, 1937
Apr 1, 1937
May 1, 1937
Jun 1, 1937
Jul 1, 1937
Aug 1, 1937
Sep 1, 1937
Oct 1, 1937
Nov 1, 1937
Dec 1, 1937
Jan 1, 1938
Feb 1, 1938
Mar 1, 1938
Apr 1, 1938
May 1, 1938
Jun 1, 1938
Jul 1, 1938
Aug 1, 1938
Sep 1, 1938
Oct 1, 1938
Nov 1, 1938
Dec 1, 1938
Jan 1, 1939
Feb 1, 1939
Mar 1, 1939
Apr 1, 1939
May 1, 1939
Jun 1, 1939
Jul 1, 1939
Aug 1, 1939
Sep 1, 1939
Oct 1, 1939
Nov 1, 1939
Dec 1, 1939
Jan 1, 1940
Feb 1, 1940
Mar 1, 1940
Apr 1, 1940
May 1, 1940
Jun 1, 1940
Jul 1, 1940
Aug 1, 1940
Sep 1, 1940
Oct 1, 1940
Nov 1, 1940
Dec 1, 1940
Jan 1, 1941
Feb 1, 1941
Mar 1, 1941
Apr 1, 1941
May 1, 1941
Jun 1, 1941
Jul 1, 1941
Aug 1, 1941
Sep 1, 1941
Oct 1, 1941
Nov 1, 1941
Dec 1, 1941
Jan 1, 1942
Feb 1, 1942
Mar 1, 1942
Apr 1, 1942
May 1, 1942
Jun 1, 1942
Jul 1, 1942
Aug 1, 1942
Sep 1, 1942
Oct 1, 1942
Nov 1, 1942
Dec 1, 1942
Jan 1, 1943
Feb 1, 1943
Mar 1, 1943
Apr 1, 1943
May 1, 1943
Jun 1, 1943
Jul 1, 1943
Aug 1, 1943
Sep 1, 1943
Oct 1, 1943
Nov 1, 1943
Dec 1, 1943
Jan 1, 1944
Feb 1, 1944
Mar 1, 1944
Apr 1, 1944
May 1, 1944
Jun 1, 1944
Jul 1, 1944
Aug 1, 1944
Sep 1, 1944
Oct 1, 1944
Nov 1, 1944
Dec 1, 1944
Jan 1, 1945
Feb 1, 1945
Mar 1, 1945
Apr 1, 1945
May 1, 1945
Jun 1, 1945
Jul 1, 1945
Aug 1, 1945
Sep 1, 1945
Oct 1, 1945
Nov 1, 1945
Dec 1, 1945
Jan 1, 1946
Feb 1, 1946
Mar 1, 1946
Apr 1, 1946
May 1, 1946
Jun 1, 1946
Jul 1, 1946
Aug 1, 1946
Sep 1, 1946
Oct 1, 1946
Nov 1, 1946
Dec 1, 1946
Jan 1, 1947
Feb 1, 1947
Mar 1, 1947
Apr 1, 1947
May 1, 1947
Jun 1, 1947
Jul 1, 1947
Aug 1, 1947
Sep 1, 1947
Oct 1, 1947
Nov 1, 1947
Dec 1, 1947
Jan 1, 1948
Feb 1, 1948
Mar 1, 1948
Apr 1, 1948
May 1, 1948
Jun 1, 1948
Jul 1, 1948
Aug 1, 1948
Sep 1, 1948
Oct 1, 1948
Nov 1, 1948
Dec 1, 1948
Jan 1, 1949
Feb 1, 1949
Mar 1, 1949
Apr 1, 1949
May 1, 1949
Jun 1, 1949
Jul 1, 1949
Aug 1, 1949
Sep 1, 1949
Oct 1, 1949
Nov 1, 1949
Dec 1, 1949
Jan 1, 1950

1011251(8)

V1251  
8